

UNSLOTTED INDENTED  
HEX WASHER HEAD  
THREAD ROLLING  
SCREW DIN 7500-D

XXXXUHWZD7500D-17
February 2019
REV 03
PAGE 1 of 1

LENGTH		TOLERANCE
FROM	INCLUSIVE	
3mm	6mm	± 0.375
6mm	10mm	± 0.45
10mm	18mm	± 0.55
18mm	30mm	± 0.65
30mm	50mm	± 0.8

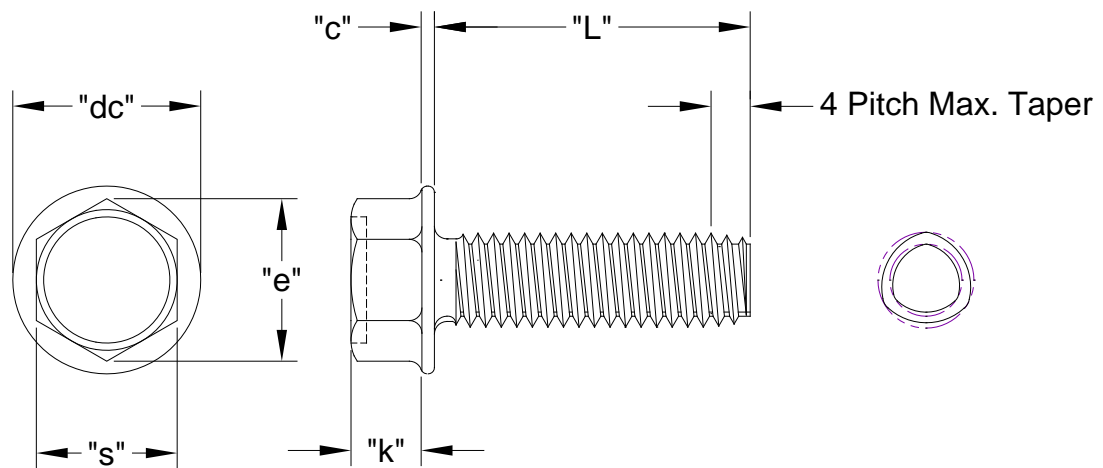

Nominal Screw Size	Tri-Lobular Body				Width Across Flats		Width Across Corners	Head Height		Washer Diameter		Washer Thickness
	Circumscribing Circle		Major Diameter		"s"		"e"	"k"		"dc"		"c"
	Max.	Min.	Max.	Min.	Max.	Min.	Min.	Max.	Min.	Max.	Min.	Max.
M2.5 x 0.45	2.570	2.480	2.480	2.390	5.00	4.88		1.80	1.32	6.40	5.9	0.50
M3 x 0.5	3.070	2.980	2.970	2.880	5.50	5.32		2.00	1.52	7.10	6.6	0.50
M4 x 0.7	4.080	3.980	3.940	3.840	7.00	6.82		3.53	3.05	8.90	8.4	0.70
M5 x 0.8	5.090	4.980	4.930	4.820	8.00	7.78		4.45	3.75	10.40	10	0.80
M6 x 1.0	6.100	5.970	5.900	5.770	10.00	9.78		5.20	4.50	13.00	12	1.05
M8x1.25	8.130	7.970	7.880	7.720	13.00	12.73		7.05	6.30	17.00	16.4	1.30

Standard: DIN 7500 Material: Steel Case Hardened Surface Hardness: 450 HV 0.3 (Rc 45 Min.) Finish: Zinc, Bake, ROHS Compliant Clear Chromate & Wax ISO 4042 Fe/Zn 3c1A	<b>COMMON USES:</b> Sheet Metal > 0.6 * Screw Dia., Extruded Sheet Metal, Zinc & Aluminum Die Casting
--	--