

SLOTTED INDENTED HEX WASHER HEAD MACHINE SCREW

XXXXSHWMZ
APRIL, 2014
REV 00
PAGE 1 of 1

Nominal Screw Size	#0 Thru #12	1/4 Thru 3/4
Nominal Screw Length	Tolerance	
Up To & Including 1/2"	-0.02	-0.03
Over 1/2 To 1", Inclusive	-0.03	-0.03
Over 1" to 2", Inclusive	-0.06	-0.06
Over 2"	-0.09	-0.09

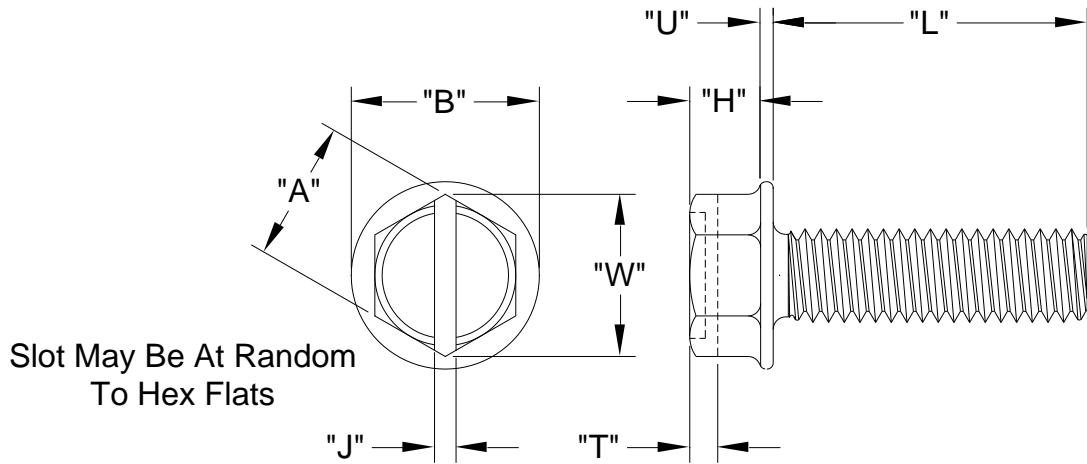

Nominal Screw Size	Basic Screw Size	Major Diameter		"A"		"W"	"H"		"B"		"U"		"J"		"T"	
				Width Across Flats		Width Across Corners	Head Height		Washer Diameter		Washer Thickness		Slot Width		Slot Depth	
		Max.	Min.	Max.	Min.	Min.	Max.	Min.	Max.	Min.	Max.	Min.	Max.	Min.	Max.	Min.
#4 - 40	0.112	0.1120	0.1061	0.188	0.181	0.202	0.060	0.049	0.243	0.225	0.019	0.011	0.039	0.031	0.042	0.025
#6 - 32	0.138	0.1380	0.1312	0.250	0.244	0.272	0.093	0.080	0.328	0.302	0.025	0.015	0.048	0.039	0.053	0.033
#8 - 32	0.164	0.1640	0.1571	0.250	0.244	0.272	0.110	0.096	0.348	0.322	0.031	0.019	0.054	0.045	0.074	0.052
#10 - 24	0.190	0.1900	0.1818	0.312	0.305	0.340	0.120	0.105	0.414	0.384	0.031	0.019	0.060	0.050	0.080	0.057
#10 - 32		0.1900	0.1831	0.375	0.367	0.409	0.190	0.172	0.520	0.480	0.050	0.030	0.075	0.064	0.111	0.083
1/4 - 20	0.250	0.2500	0.2408	0.500	0.489	0.545	0.230	0.208	0.676	0.624	0.055	0.035	0.084	0.072	0.134	0.100
5/16 - 18	0.313	0.3125	0.3026													

Standard: ASME B18.6.3 Material: Carbon Steel, 60,000 psi Minimum Tensile Stress Finish: Commercial Zinc & ROHS Compliant Clear Chromate Per ASTM F1941 Code Fe/Zn 3A	Common Uses: Nuts, Tapped Holes, Threaded Inserts Increased bearing surface without adding a washer; Reduces embedment.
--	--